

Great Yarmouth Third River Crossing Order 202[*]

Document NCC/GY3RC/EX/004: Update to Land Plans

Planning Act 2008

Infrastructure Planning

The Infrastructure Planning (Examination Procedure) Rules 2010

Planning Inspectorate Reference Number: TR010043

Author: Norfolk County Council

Document Reference: NCC/GY3RC/EX/004

Date: 13 September 2019



This page is intentionally left blank

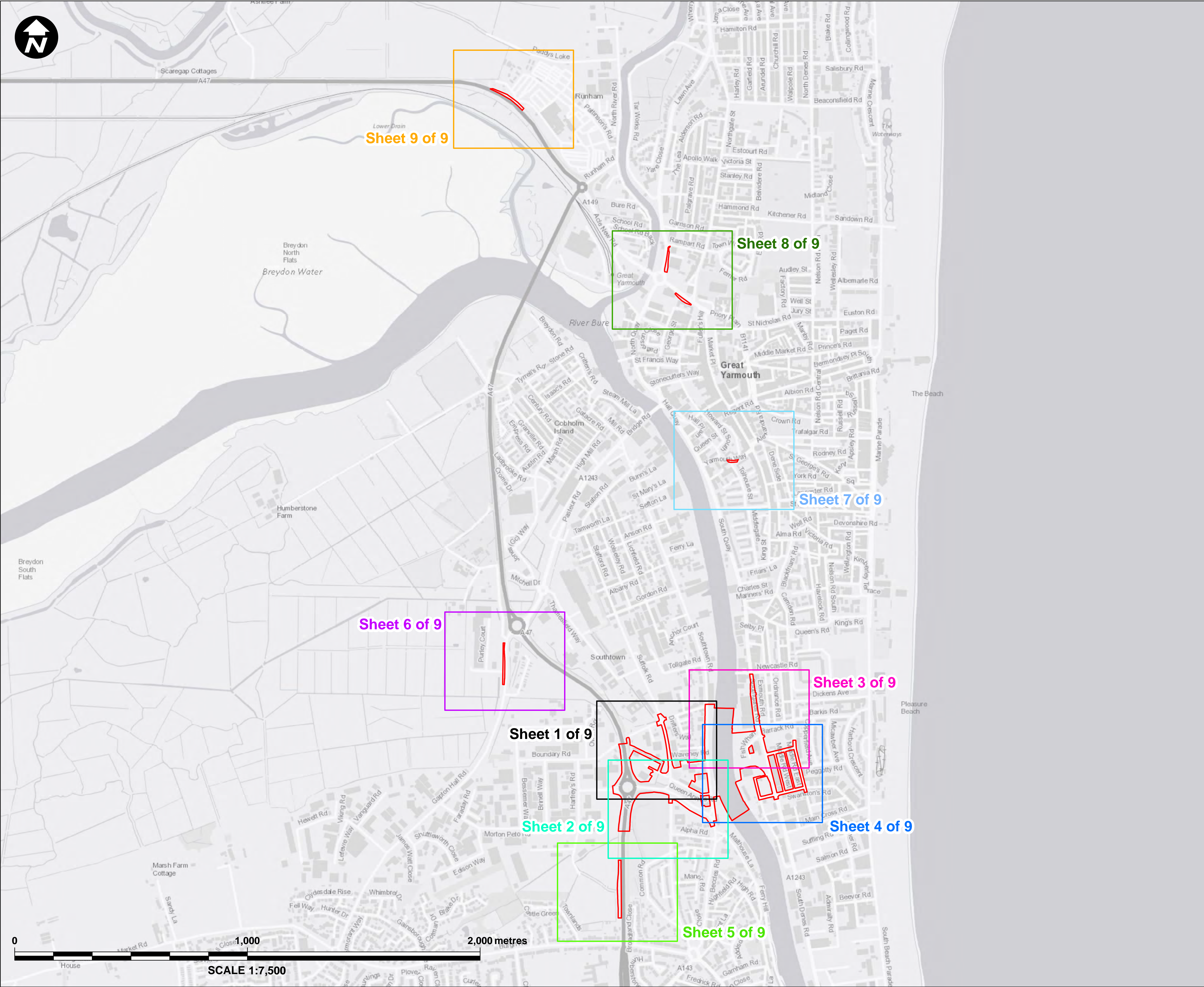

Key:

- Order Limits
- Sheet 1 of 9
- Sheet 2 of 9
- Sheet 3 of 9
- Sheet 4 of 9
- Sheet 5 of 9
- Sheet 6 of 9
- Sheet 7 of 9
- Sheet 8 of 9
- Sheet 9 of 9

NOTES:
1. This plan should be read in conjunction with the Development Consent Order and the documents it refers to, in particular the Book of Reference and Schedules 6, 8 and 9 of the Development Consent Order.

Mapping reproduced by permission of Ordnance Survey on behalf of HMSO.
© Crown copyright and database rights 2018 Ordnance Survey 100019340.

REVISION	DRAWN	CHECKED	APPROVED	DATE
DESCRIPTION				

 **Norfolk** County Council
Tom McCabe
Executive Director of
Community and Environmental Services
Norfolk County Council
County Hall, Martineau Lane
Norwich NR1 2SG

PROJECT TITLE
**GREAT YARMOUTH
THIRD RIVER CROSSING**

DRAWING TITLE
**DCO DOCUMENT 2.5
LAND PLANS
KEY PLAN
(REGULATIONS 5(2)(i) & 5(4))**

DRAWING STATUS
FOR DCO APPLICATION

DRAWN	CHECKED	APPROVED	AUTHORISED
DE	SC	GBr	MK

SCALE @ A1 SIZE	DATE	REVISION
1:7,500	12/04/2019	P00

DRAWING NUMBER
GYTRC-WSP-LSI-XX-DR-GI-1013

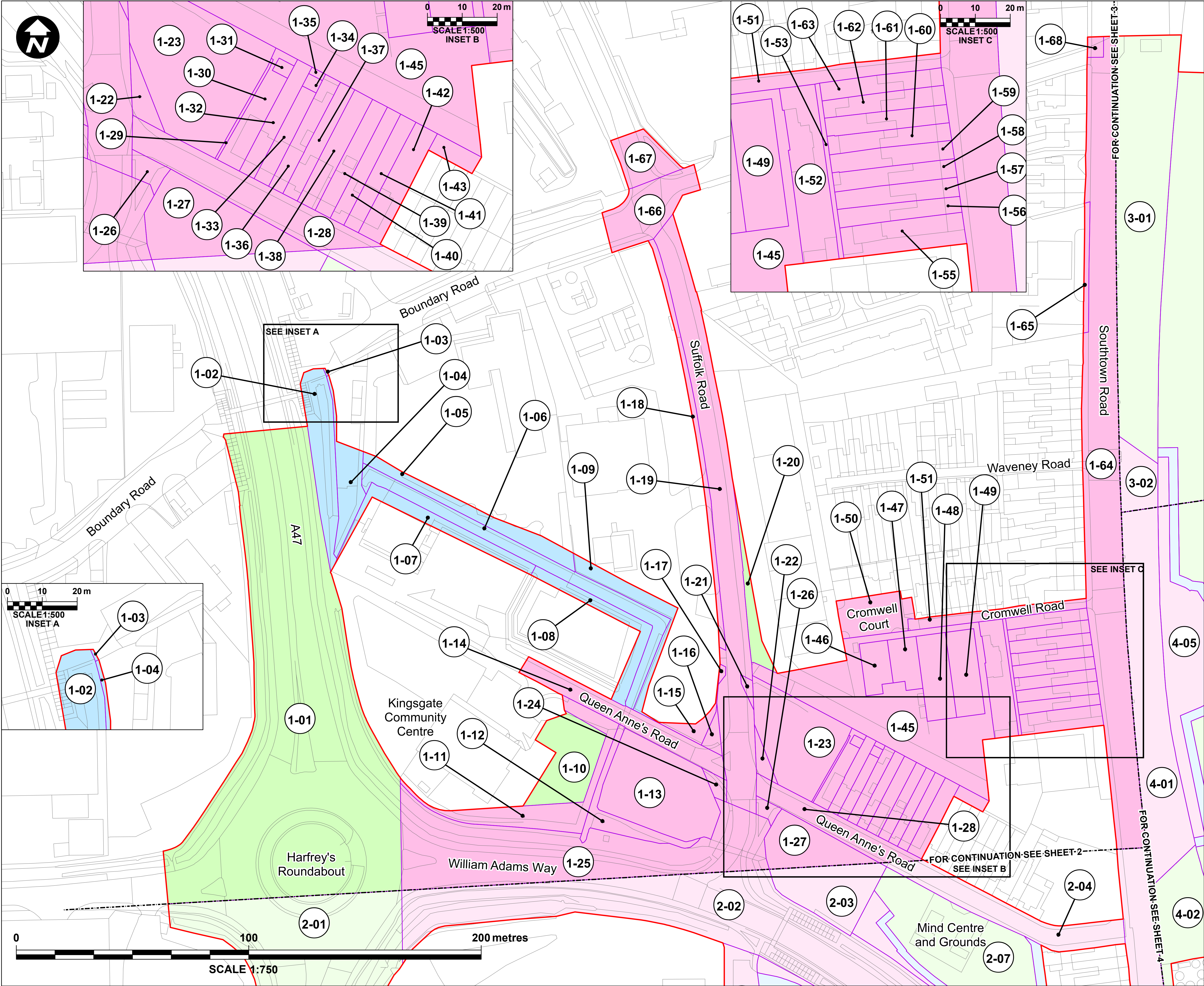

Key:

- Order Limits
- Land Use and Plot Boundary
- Permanent Acquisition of Land
- Permanent Acquisition of Rights over Land
- Permanent Acquisition of Airspace and Rights over Land
- Temporary Possession of Land
- Plot Number

NOTES:

- This plan should be read in conjunction with the Development Consent Order and the documents it refers to, in particular the Book of Reference and Schedules 6, 8 and 9 of the Development Consent Order.
- The numbers relate to plot numbers. Please refer to the Book of Reference for more information about these plots, including the approximate area of each plot (in square metres).
- Plot numbers employ the following convention. The plot number comprises the number of the sheet on which the plot is shown, followed by a unique plot identifier. For example: Plot 2-05 means plot 5 on sheet 2 ("2" is the sheet number (sheet 2) and "05" is the plot identifying number).
- To assist with understanding the context of the plots identified on this sheet and their relationship with plots identified on other sheets, where land comprised in this sheet includes a plot (or part of a plot) identified on another sheet, the number of that plot is indicated on this sheet together with its status (indicated by a paler equivalent of the relevant colouration).

Mapping reproduced by permission of Ordnance Survey on behalf of HMSO.
© Crown copyright and database rights 2018 Ordnance Survey 100019340.

REVISION	DRAWN	CHECKED	APPROVED	DATE

Norfolk County Council
Tom McCabe
Executive Director of
Community and Environmental Services
Norfolk County Council
County Hall, Martineau Lane
Norwich NR1 2SG

PROJECT TITLE

**GREAT YARMOUTH
THIRD RIVER CROSSING**

DRAWING TITLE

DCO DOCUMENT 2.5
LAND PLANS
SHEET 1 OF 9
(REGULATION 5(2)(i))

DRAWING STATUS

FOR DCO APPLICATION

DRAWN	CHECKED	APPROVED	AUTHORISED
DE	SC	GBr	MK

SCALE @ A1 SIZE	DATE	REVISION
1:750	11/04/2019	P00

DRAWING NUMBER

GYTRC-WSP-LSI-XX-DR-GI-1014

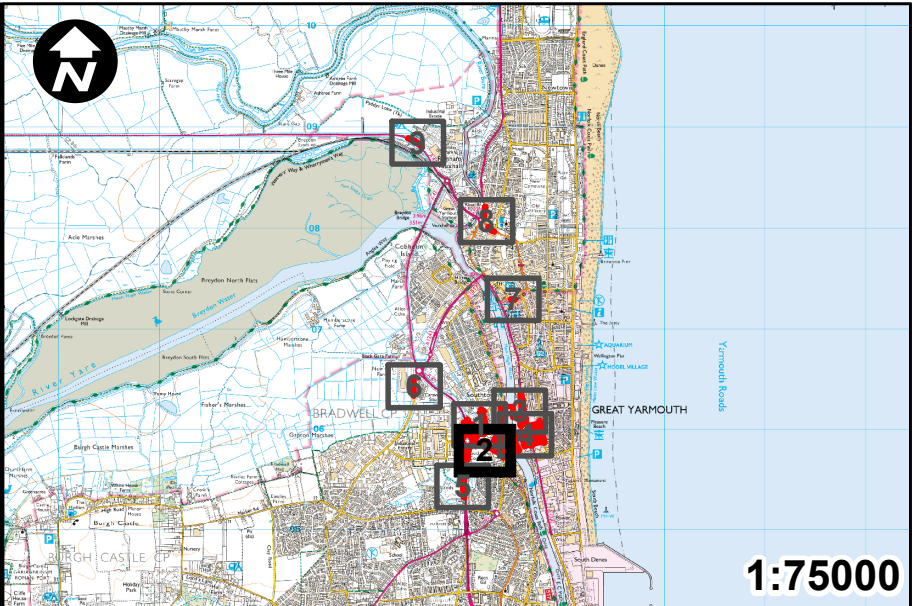
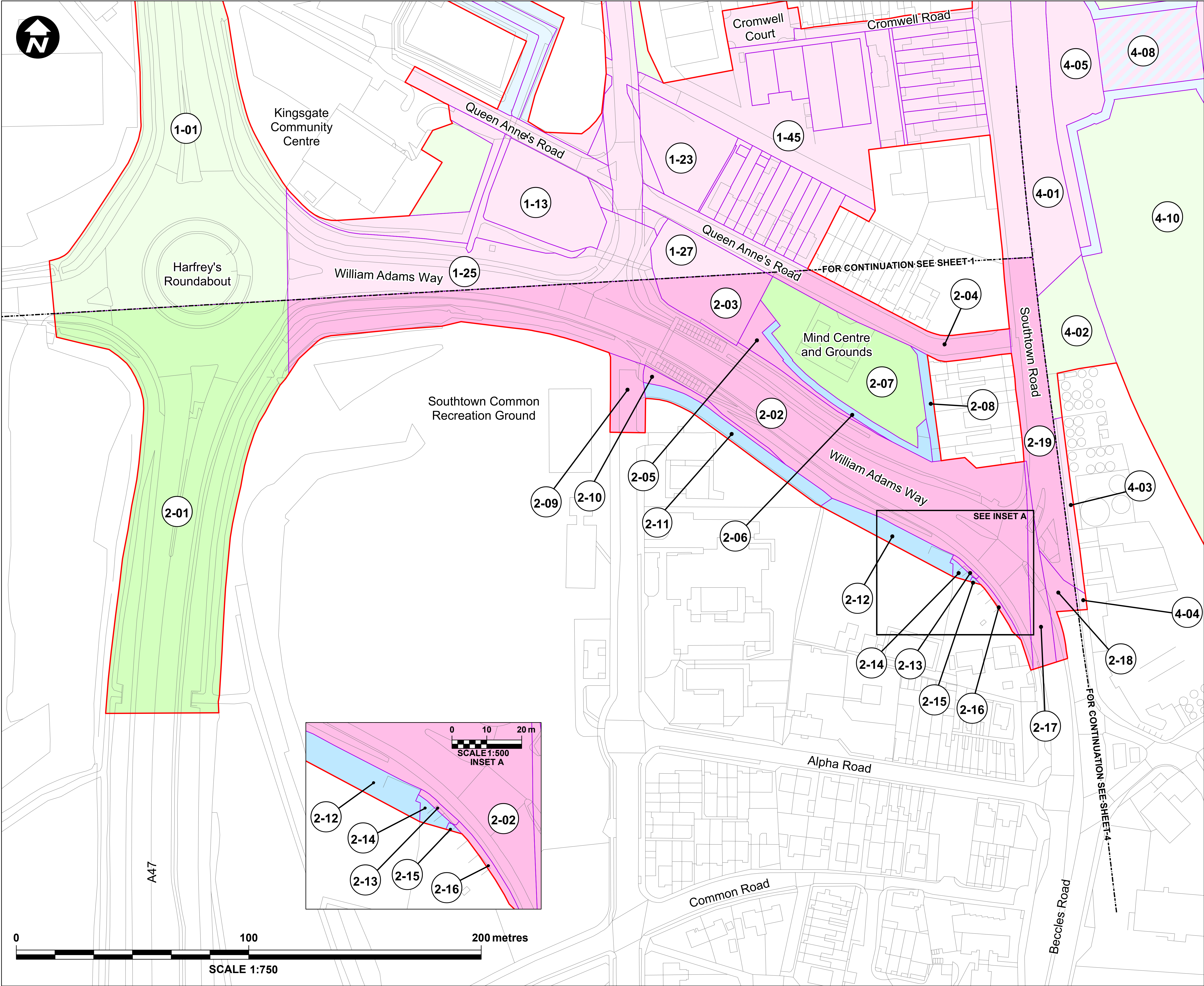

Key:

- Order Limits
- Land Use and Plot Boundary
- Permanent Acquisition of Land
- Permanent Acquisition of Rights over Land
- Permanent Acquisition of Airspace and Rights over Land
- Temporary Possession of Land
- Plot Number

- NOTES:**
1. This plan should be read in conjunction with the Development Consent Order and the documents it refers to, in particular the Book of Reference and Schedules 6, 8 and 9 of the Development Consent Order.
 2. The numbers relate to plot numbers. Please refer to the Book of Reference for more information about these plots, including the approximate area of each plot (in square metres).
 3. Plot numbers employ the following convention. The plot number comprises the number of the sheet on which the plot is shown, followed by a unique plot identifier. For example: Plot 2-05 means plot 5 on sheet 2 ("2" is the sheet number (sheet 2) and "05" is the plot identifying number).
 4. To assist with understanding the context of the plots identified on this sheet and their relationship with plots identified on other sheets, where land comprised in this sheet includes a plot (or part of a plot) identified on another sheet, the number of that plot is indicated on this sheet together with its status (indicated by a paler equivalent of the relevant colouration).

Mapping reproduced by permission of Ordnance Survey on behalf of HMSO.
© Crown copyright and database rights 2018 Ordnance Survey 100019340.

P01	DE	SC	GBr	14/08/2019
FOR DCO EXAMINATION				
P00	DE	SC	GBr	11/04/2019
FOR DCO APPLICATION				
REVISION	DRAWN	CHECKED	APPROVED	DATE
DESCRIPTION				

Norfolk County Council
Tom McCabe
Executive Director of
Community and Environmental Services
Norfolk County Council
County Hall, Martineau Lane
Norwich NR1 2SG

PROJECT TITLE
**GREAT YARMOUTH
THIRD RIVER CROSSING**





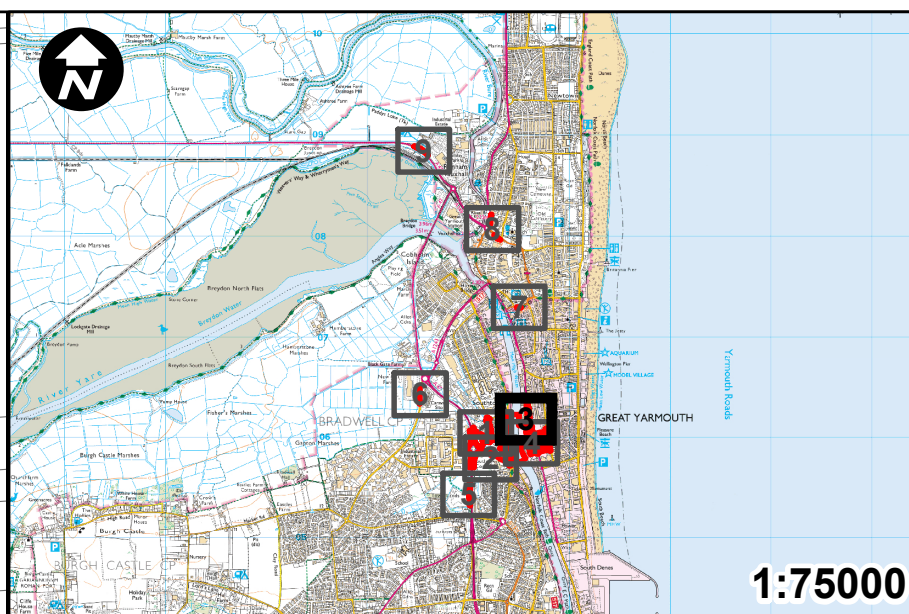
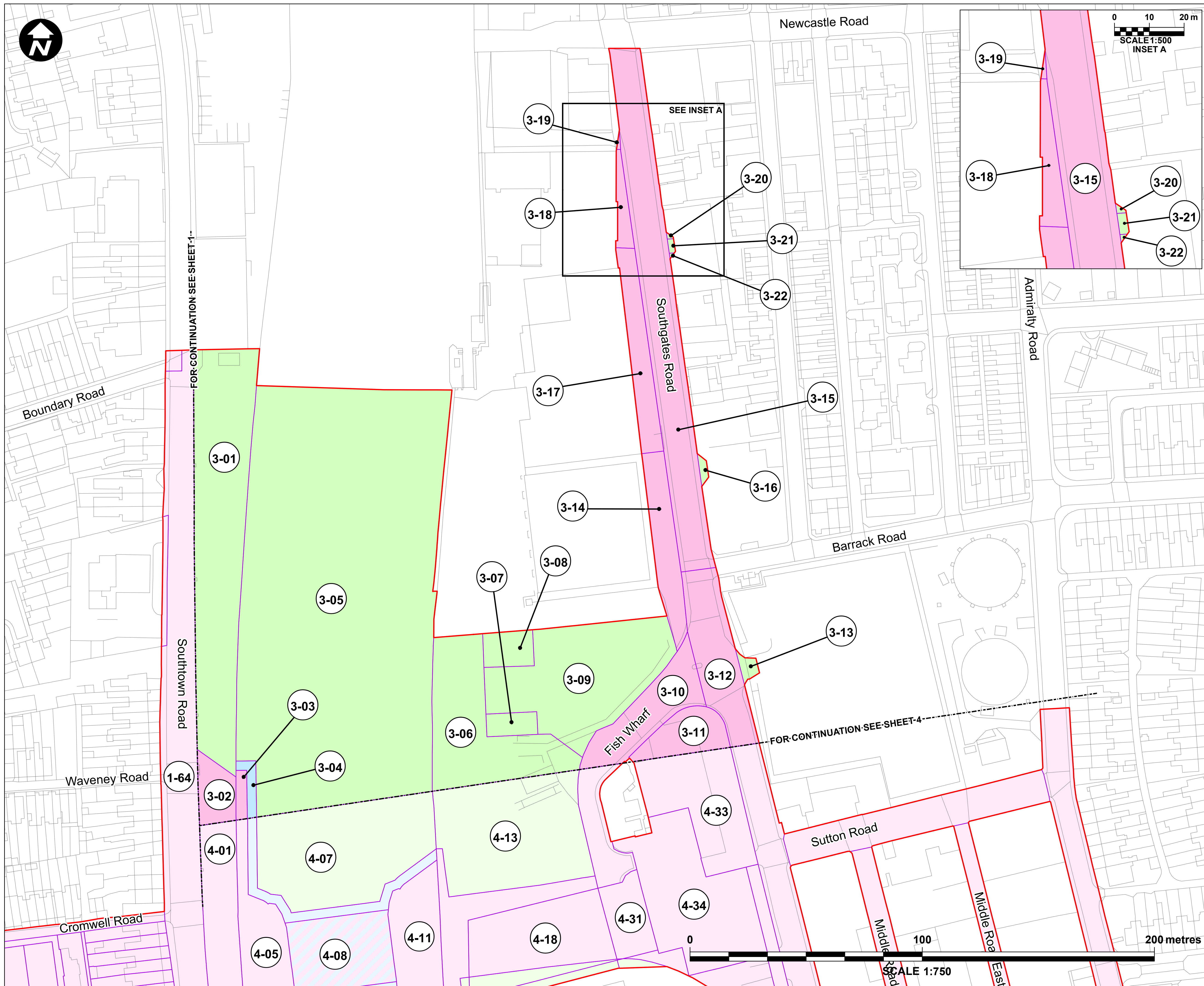

DRAWING TITLE
DCO DOCUMENT 2.5
LAND PLANS
SHEET 2 OF 9
(REGULATION 5(2)(i))

DRAWING STATUS
FOR DCO EXAMINATION

DRAWN	CHECKED	APPROVED	AUTHORISED
DE	SC	GBr	MK
SCALE @ A1 SIZE		DATE	REVISION
1:750		14/08/2019	P01

DRAWING NUMBER
GYTRC-WSP-LSI-XX-DR-GI-1015



- Key:**
- | | |
|---|--|
|  | Order Limits |
| Land Use and Plot Boundary | |
|  | Permanent Acquisition of Land |
|  | Permanent Acquisition of Rights over Land |
|  | Permanent Acquisition of Airspace and Rights over Land |
|  | Temporary Possession of Land |
|  | Plot Number |

NOTES:

1. This plan should be read in conjunction with the Development Consent Order and the documents it refers to, in particular the Book of Reference and Schedules 6, 8 and 9 of the Development Consent Order.
2. The numbers relate to plot numbers. Please refer to the Book of Reference for more information about these plots, including the approximate area of each plot (in square metres).
3. Plot numbers employ the following convention. The plot number comprises the number of the sheet on which the plot is shown, followed by a unique plot identifier. For example: Plot 2-05 means plot 5 on sheet 2 ("2" is the sheet number (sheet 2) and "05" is the plot identifying number).
4. To assist with understanding the context of the plots identified on this sheet and their relationship with plots identified on other sheets, where land comprised in this sheet includes a plot (or part of a plot) identified on another sheet, the number of that plot is indicated on this sheet together with its status (indicated by a paler equivalent of the relevant colouration).

Mapping reproduced by permission of Ordnance Survey on
behalf of HMSO.
© Crown copyright and database rights 2018 Ordnance
Survey 100019340.

[illegible]

REVISION	DRAWN	CHECKED	APPROVED	DATE
DESCRIPTION				

 **Norfolk** County Council

Tom McCabe
Executive Director of
Community and Environmental Services
Norfolk County Council
County Hall, Martineau Lane
Norwich NR1 2SG

PROJECT TITLE

**GREAT YARMOUTH
THIRD RIVER CROSSING**

DRAWING TITLE

DCO DOCUMENT 2.5
LAND PLANS
SHEET 3 OF 9
(REGULATION 5(2)(i))

DRAWING STATUS
FOR DCO APPLICATION

RAWN	CHECKED	APPROVED	AUTHORISED
DE	SC	GBr	MK

CALE @ A1 SIZE 1:750	DATE 11/04/2019	REVISION P00
-------------------------	--------------------	-----------------

RAWING NUMBER

GYTRC-WSP-LSI-XX-DR-GI-1016

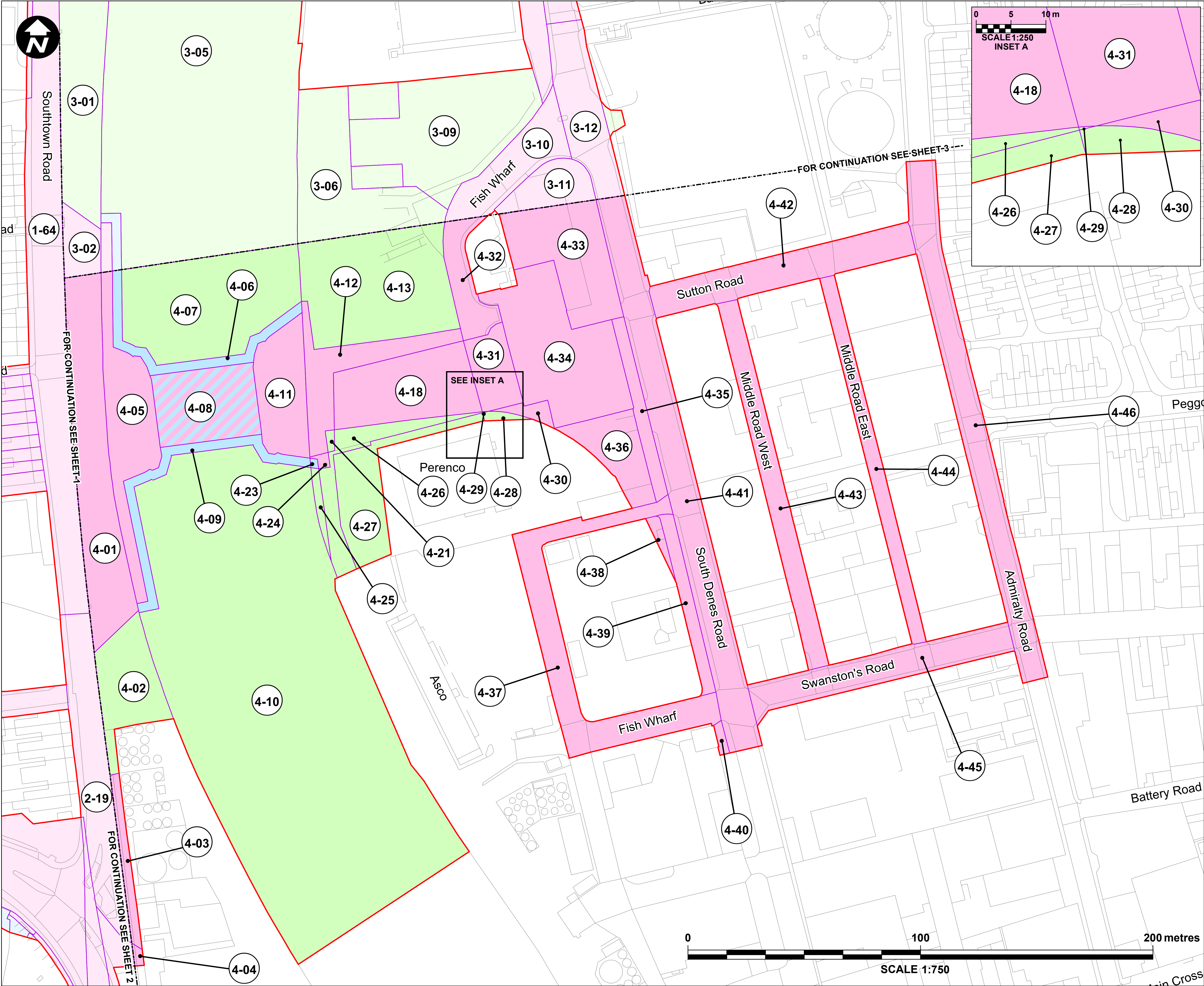

0

5

10 m

SCALE 1:250

INSET A

4-18

4-26

4-27

4-29

4-28

4-30

4-31

Key:

Order Limits

Land Use and Plot Boundary

Permanent Acquisition of Land

Permanent Acquisition of Rights over Land

Permanent Acquisition of Airspace and Rights over Land

Temporary Possession of Land

Plot Number

NOTES:

1. This plan should be read in conjunction with the Development Consent Order and the documents it refers to, in particular the Book of Reference and Schedules 6, 8 and 9 of the Development Consent Order.

2. The numbers relate to plot numbers. Please refer to the Book of Reference for more information about these plots, including the approximate area of each plot (in square metres).

3. Plot numbers employ the following convention. The plot number comprises the number of the sheet on which the plot is shown, followed by a unique plot identifier. For example: Plot 2-05 means plot 5 on sheet 2 ("2" is the sheet number (sheet 2) and "05" is the plot identifying number).

4. To assist with understanding the context of the plots identified on this sheet and their relationship with plots identified on other sheets, where land comprised in this sheet includes a plot (or part of a plot) identified on another sheet, the number of that plot is indicated on this sheet together with its status (indicated by a paler equivalent of the relevant colouration).

Mapping reproduced by permission of Ordnance Survey on behalf of HMSO.

© Crown copyright and database rights 2018 Ordnance Survey 100019340.

P01	DE	SC	GBr	14/08/2019																				
FOR DCO EXAMINATION																								
P00	DE	SC	GBr	12/04/2019																				
FOR DCO APPLICATION																								
REVISION	DRAWN	CHECKED	APPROVED	DATE																				
DESCRIPTION																								
<div><div><div><div></div><div>Tom McCabe</div><div>Executive Director of Community and Environmental Services</div><div>Norfolk County Council</div><div>County Hall, Martineau Lane</div><div>Norwich NR1 2SG</div></div><div><div>Norfolk</div><div>County Council</div></div></div></div> <div><div>PROJECT TITLE</div><div>GREAT YARMOUTH</div><div>THIRD RIVER CROSSING</div></div> <div><div>DRAWING TITLE</div><div>DCO DOCUMENT 2.5</div><div>LAND PLANS</div><div>SHEET 4 OF 9</div><div>(REGULATION 5(2)(i))</div></div> <div><div>DRAWING STATUS</div><div>FOR DCO EXAMINATION</div></div> <table><tr><td>DRAWN</td><td>CHECKED</td><td>APPROVED</td><td>AUTHORISED</td></tr><tr><td>DE</td><td>SC</td><td>GBr</td><td>MK</td></tr><tr><td colspan="2">SCALE @ A1 SIZE</td><td>DATE</td><td>REVISION</td></tr><tr><td colspan="2">1:750</td><td>14/08/2019</td><td>P01</td></tr><tr><td colspan="4">DRAWING NUMBER</td></tr><tr><td colspan="4">GYTRC-WSP-LSI-XX-DR-GI-1017</td></tr></table>	DRAWN	CHECKED	APPROVED	AUTHORISED	DE	SC	GBr	MK	SCALE @ A1 SIZE		DATE	REVISION	1:750		14/08/2019	P01	DRAWING NUMBER				GYTRC-WSP-LSI-XX-DR-GI-1017			
DRAWN	CHECKED	APPROVED	AUTHORISED																					
DE	SC	GBr	MK																					
SCALE @ A1 SIZE		DATE	REVISION																					
1:750		14/08/2019	P01																					
DRAWING NUMBER																								
GYTRC-WSP-LSI-XX-DR-GI-1017																								

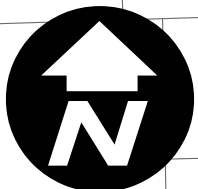
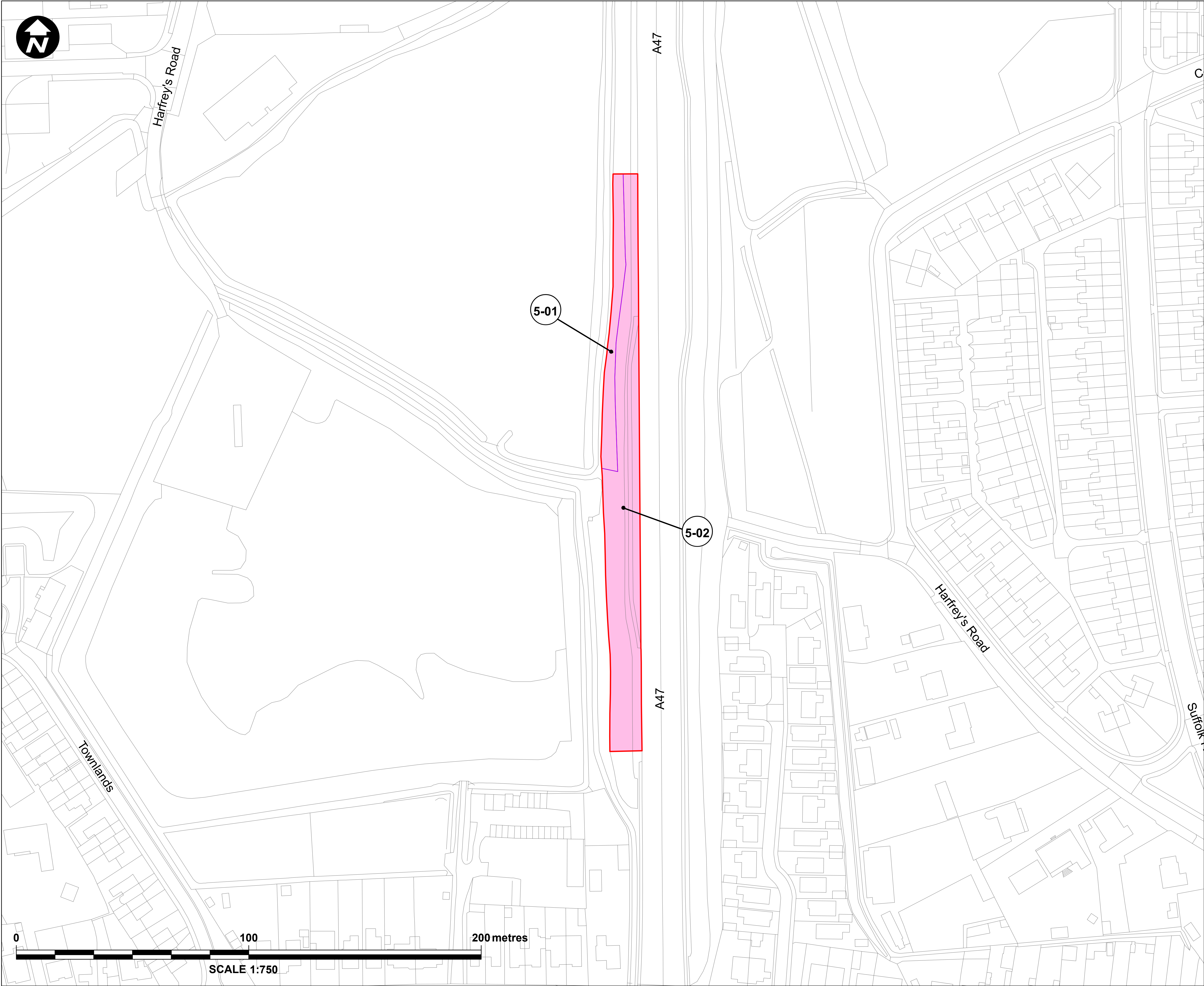

Harfrey's Road

A47

A47

Harfrey's Road

Suffolk

Townlands

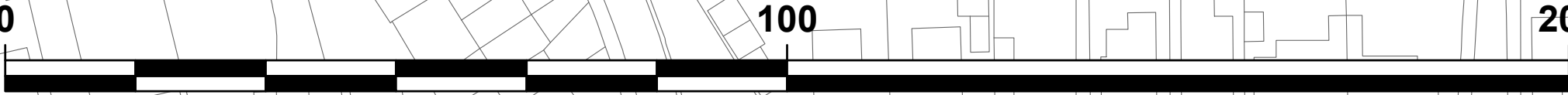

SCALE 1:750

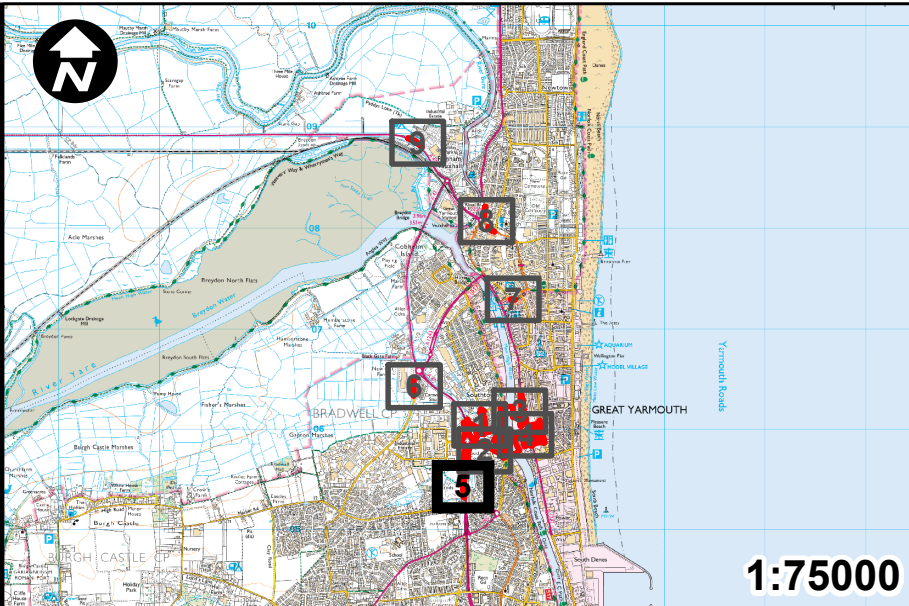

Key:

- Order Limits
- Land Use and Plot Boundary
- Permanent Acquisition of Land
- Permanent Acquisition of Rights over Land
- Permanent Acquisition of Airspace and Rights over Land
- Temporary Possession of Land

1-01 Plot Number

NOTES:

1. This plan should be read in conjunction with the Development Consent Order and the documents it refers to, in particular the Book of Reference and Schedules 6, 8 and 9 of the Development Consent Order.

2. The numbers relate to plot numbers. Please refer to the Book of Reference for more information about these plots, including the approximate area of each plot (in square metres).

3. Plot numbers employ the following convention. The plot number comprises the number of the sheet on which the plot is shown, followed by a unique plot identifier. For example: Plot 2-05 means plot 5 on sheet 2 ("2" is the sheet number (sheet 2) and "05" is the plot identifying number).

4. To assist with understanding the context of the plots identified on this sheet and their relationship with plots identified on other sheets, where land comprised in this sheet includes a plot (or part of a plot) identified on another sheet, the number of that plot is indicated on this sheet together with its status (indicated by a paler equivalent of the relevant colouration).

Mapping reproduced by permission of Ordnance Survey on behalf of HMSO.
© Crown copyright and database rights 2018 Ordnance Survey 100019340.

REVISION	DRAWN	CHECKED	APPROVED	DATE
DESCRIPTION				

 **Norfolk** County Council

Tom McCabe
Executive Director of
Community and Environmental Services
Norfolk County Council
County Hall, Martineau Lane
Norwich NR1 2SG

PROJECT TITLE

**GREAT YARMOUTH
THIRD RIVER CROSSING**

DRAWING TITLE

DCO DOCUMENT 2.5
LAND PLANS
SHEET 5 OF 9
(REGULATION 5(2)(i))

DRAWING STATUS

FOR DCO APPLICATION

DRAWN	CHECKED	APPROVED	AUTHORISED
DE	SC	GBr	MK

SCALE @ A1 SIZE	DATE	REVISION
1:750	05/04/2019	P00

DRAWING NUMBER

GYTRC-WSP-LSI-XX-DR-GI-1018

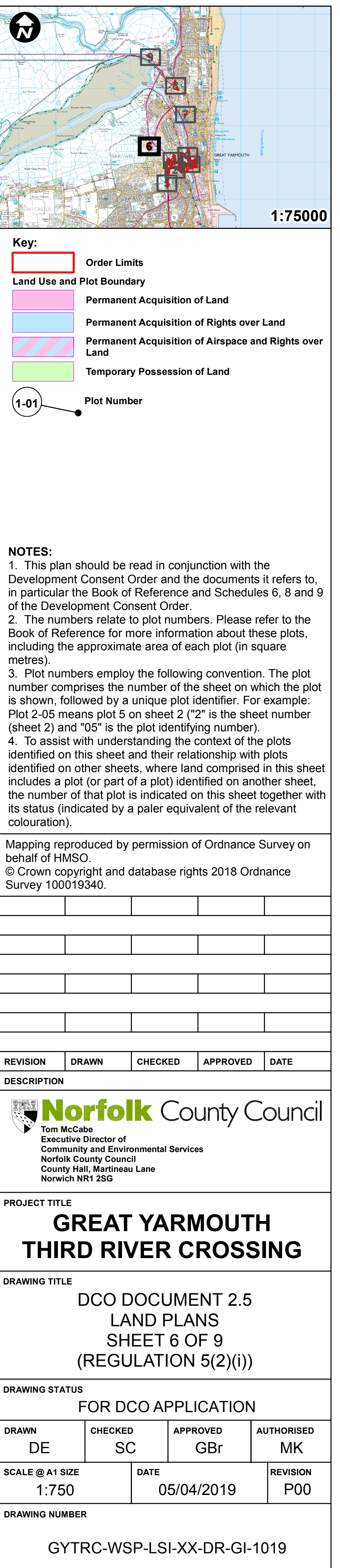
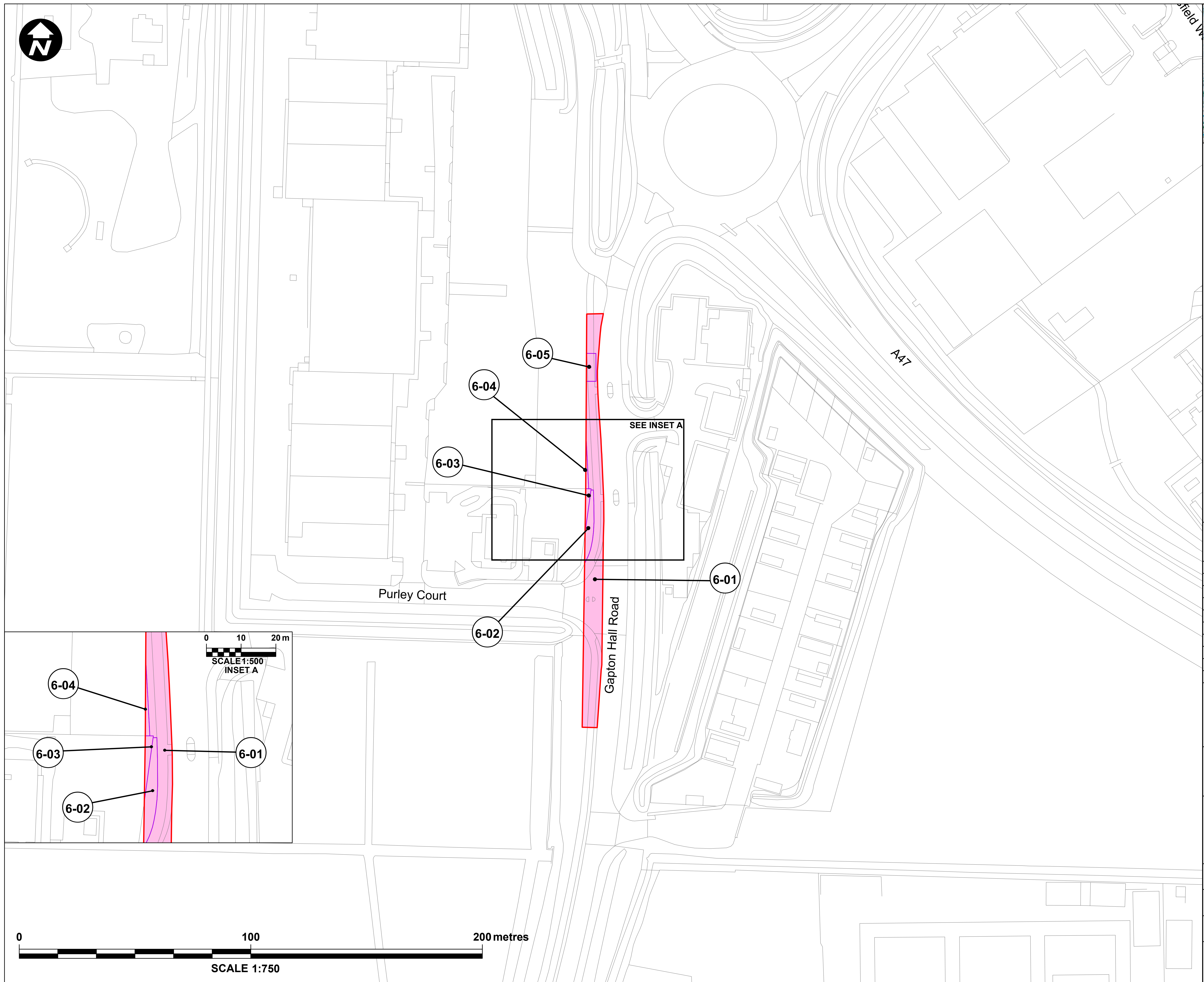

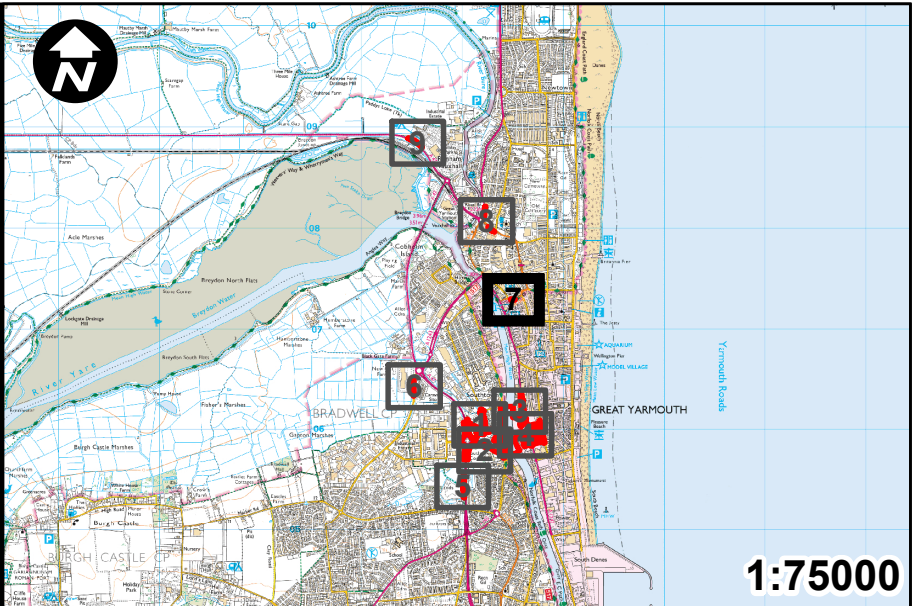
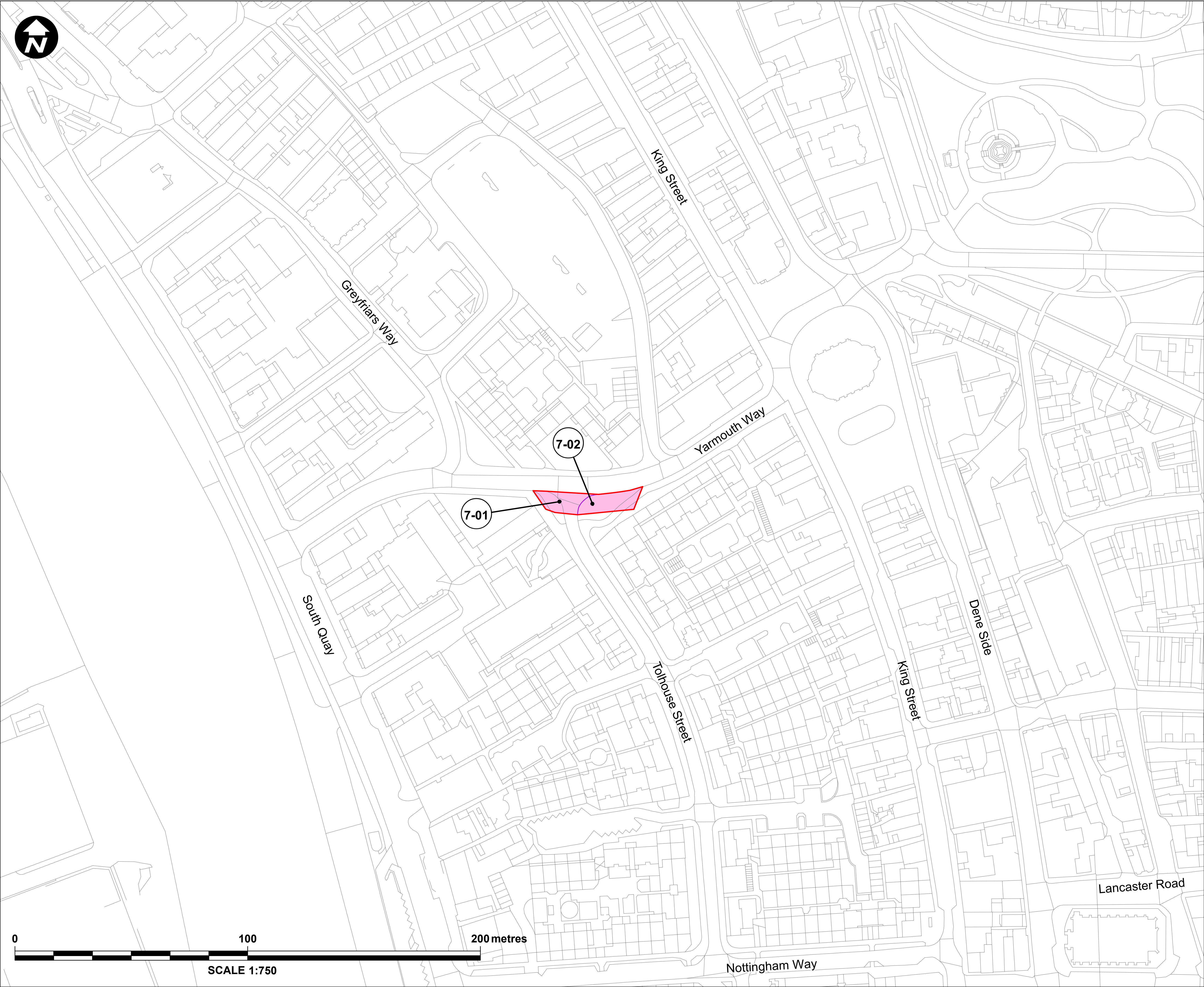

Key:

Order Limits

Land Use and Plot Boundary

Permanent Acquisition of Land

Permanent Acquisition of Rights over Land

Permanent Acquisition of Airspace and Rights over Land

Temporary Possession of Land

1-01 Plot Number

NOTES:

1. This plan should be read in conjunction with the Development Consent Order and the documents it refers to, in particular the Book of Reference and Schedules 6, 8 and 9 of the Development Consent Order.

2. The numbers relate to plot numbers. Please refer to the Book of Reference for more information about these plots, including the approximate area of each plot (in square metres).

3. Plot numbers employ the following convention. The plot number comprises the number of the sheet on which the plot is shown, followed by a unique plot identifier. For example: Plot 2-05 means plot 5 on sheet 2 ("2" is the sheet number (sheet 2) and "05" is the plot identifying number).

4. To assist with understanding the context of the plots identified on this sheet and their relationship with plots identified on other sheets, where land comprised in this sheet includes a plot (or part of a plot) identified on another sheet, the number of that plot is indicated on this sheet together with its status (indicated by a paler equivalent of the relevant colouration).

Mapping reproduced by permission of Ordnance Survey on behalf of HMSO.
© Crown copyright and database rights 2018 Ordnance Survey 100019340.

REVISION	DRAWN	CHECKED	APPROVED	DATE
DESCRIPTION				

**Norfolk** County Council

Tom McCabe
Executive Director of
Community and Environmental Services
Norfolk County Council
County Hall, Martineau Lane
Norwich NR1 2SG

PROJECT TITLE

**GREAT YARMOUTH
THIRD RIVER CROSSING**

DRAWING TITLE

DCO DOCUMENT 2.5
LAND PLANS
SHEET 7 OF 9
(REGULATION 5(2)(i))

DRAWING STATUS

FOR DCO APPLICATION

DRAWN	CHECKED	APPROVED	AUTHORISED
DE	SC	GBr	MK

SCALE @ A1 SIZE	DATE	REVISION
1:750	05/04/2019	P00

DRAWING NUMBER

GYTRC-WSP-LSI-XX-DR-GI-1020

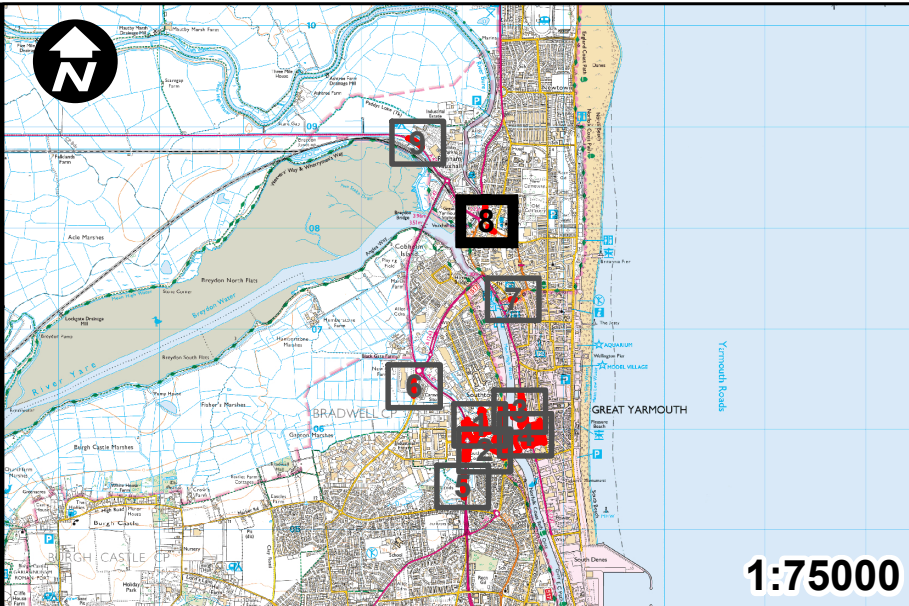
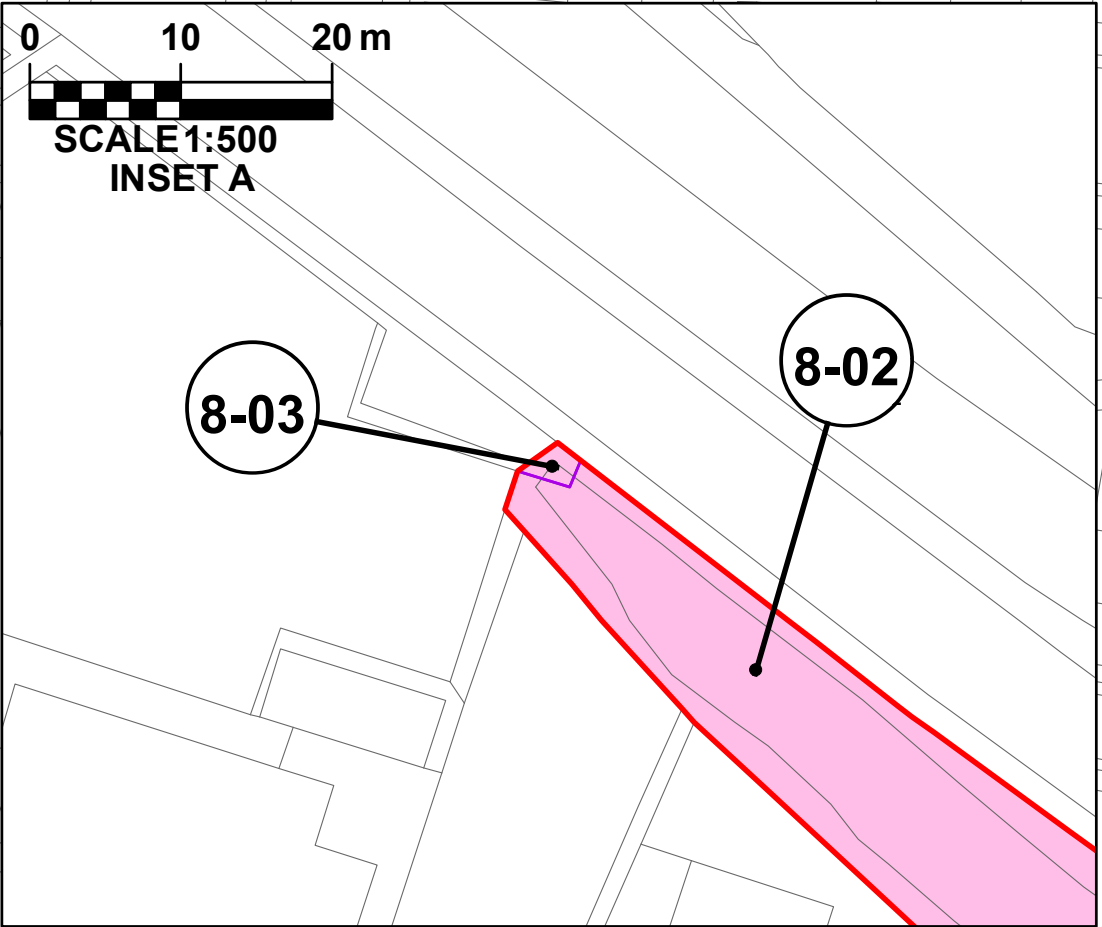
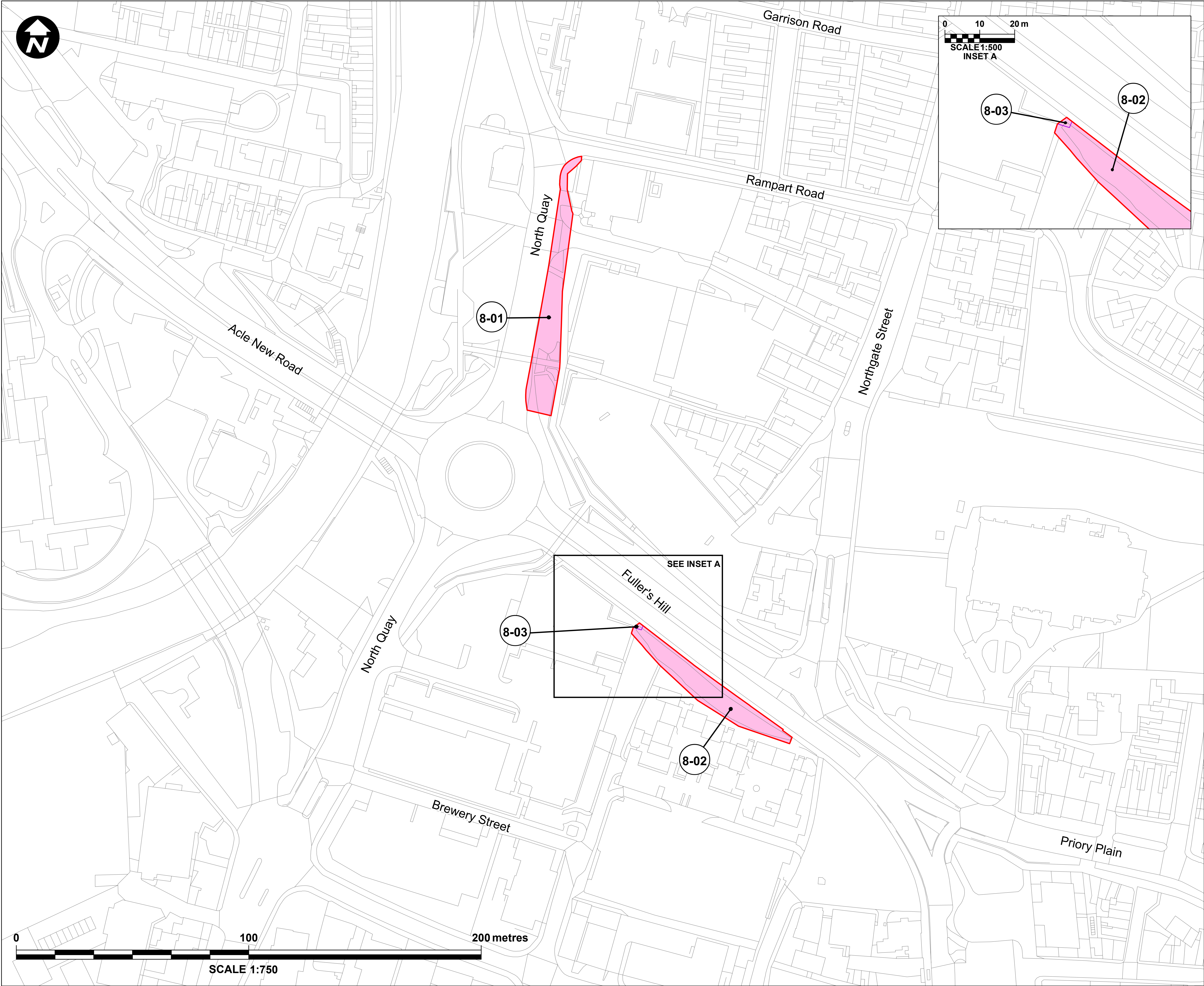

- Key:**
- Order Limits
 - Land Use and Plot Boundary
 - Permanent Acquisition of Land
 - Permanent Acquisition of Rights over Land
 - Permanent Acquisition of Airspace and Rights over Land
 - Temporary Possession of Land
 - Plot Number

NOTES:

1. This plan should be read in conjunction with the Development Consent Order and the documents it refers to, in particular the Book of Reference and Schedules 6, 8 and 9 of the Development Consent Order.

2. The numbers relate to plot numbers. Please refer to the Book of Reference for more information about these plots, including the approximate area of each plot (in square metres).

3. Plot numbers employ the following convention. The plot number comprises the number of the sheet on which the plot is shown, followed by a unique plot identifier. For example: Plot 2-05 means plot 5 on sheet 2 ("2" is the sheet number (sheet 2) and "05" is the plot identifying number).

4. To assist with understanding the context of the plots identified on this sheet and their relationship with plots identified on other sheets, where land comprised in this sheet includes a plot (or part of a plot) identified on another sheet, the number of that plot is indicated on this sheet together with its status (indicated by a paler equivalent of the relevant colouration).

Mapping reproduced by permission of Ordnance Survey on behalf of HMSO.
© Crown copyright and database rights 2018 Ordnance Survey 100019340.

REVISION	DRAWN	CHECKED	APPROVED	DATE
DESCRIPTION				

 **Norfolk County Council**
Tom McCabe
Executive Director of
Community and Environmental Services
Norfolk County Council
County Hall, Martineau Lane
Norwich NR1 2SG

PROJECT TITLE
**GREAT YARMOUTH
THIRD RIVER CROSSING**

DRAWING TITLE
DCO DOCUMENT 2.5
LAND PLANS
SHEET 8 OF 9
(REGULATION 5(2)(i))

DRAWING STATUS
FOR DCO APPLICATION

DRAWN	CHECKED	APPROVED	AUTHORISED
DE	SC	GBr	MK

SCALE @ A1 SIZE	DATE	REVISION
1:750	11/04/2019	P00

DRAWING NUMBER
GYTRC-WSP-LSI-XX-DR-GI-1021



A47

Acle New Road

Pattinson's Road

A47

9-01

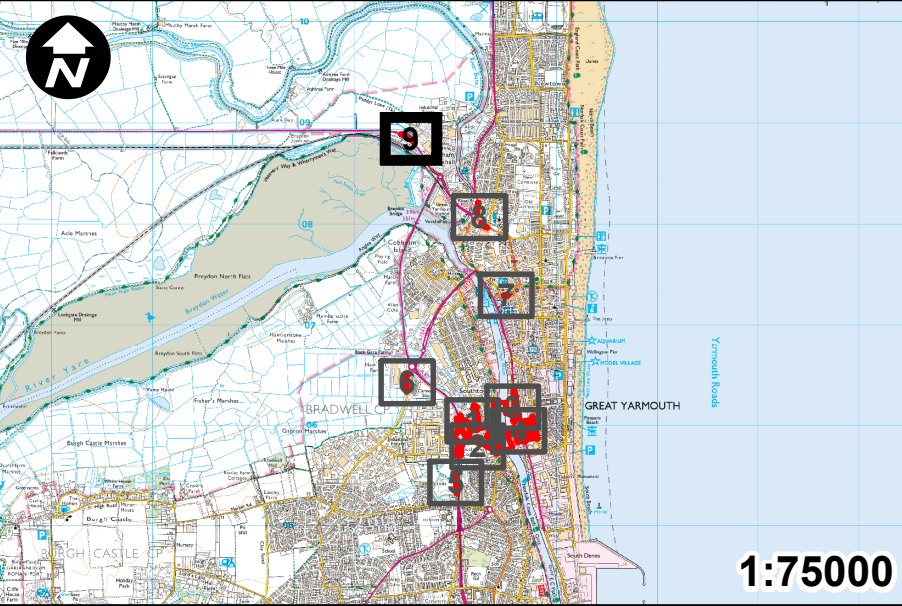
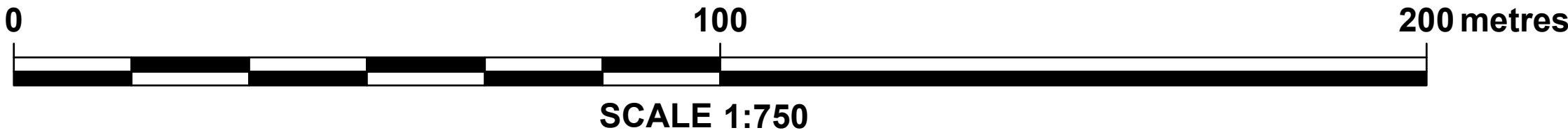

Key:

- Order Limits
- Land Use and Plot Boundary
- Permanent Acquisition of Land
- Permanent Acquisition of Rights over Land
- Permanent Acquisition of Airspace and Rights over Land
- Temporary Possession of Land

1-01 Plot Number

- NOTES:**
1. This plan should be read in conjunction with the Development Consent Order and the documents it refers to, in particular the Book of Reference and Schedules 6, 8 and 9 of the Development Consent Order.
 2. The numbers relate to plot numbers. Please refer to the Book of Reference for more information about these plots, including the approximate area of each plot (in square metres).
 3. Plot numbers employ the following convention. The plot number comprises the number of the sheet on which the plot is shown, followed by a unique plot identifier. For example: Plot 2-05 means plot 5 on sheet 2 ("2" is the sheet number (sheet 2) and "05" is the plot identifying number).
 4. To assist with understanding the context of the plots identified on this sheet and their relationship with plots identified on other sheets, where land comprised in this sheet includes a plot (or part of a plot) identified on another sheet, the number of that plot is indicated on this sheet together with its status (indicated by a paler equivalent of the relevant colouration).

Mapping reproduced by permission of Ordnance Survey on behalf of HMSO.
© Crown copyright and database rights 2018 Ordnance Survey 100019340.

REVISION	DRAWN	CHECKED	APPROVED	DATE
DESCRIPTION				



Norfolk County Council

Tom McCabe
Executive Director of
Community and Environmental Services
Norfolk County Council
County Hall, Martineau Lane
Norwich NR1 2SG

PROJECT TITLE

**GREAT YARMOUTH
THIRD RIVER CROSSING**

DRAWING TITLE

DCO DOCUMENT 2.5
LAND PLANS
SHEET 9 OF 9
(REGULATION 5(2)(i))

DRAWING STATUS

FOR DCO APPLICATION

DRAWN	CHECKED	APPROVED	AUTHORISED
DE	SC	GBr	MK

SCALE @ A1 SIZE	DATE	REVISION
1:750	12/04/2019	P00

DRAWING NUMBER

GYTRC-WSP-LSI-XX-DR-GI-1022